

TopSolid' PunchCut



Powerful **CAD/CAM** solution for **sheet metal** processing

- Perfect utilization of all manufacturing techniques: punching, 2 to 3-axis-cutting, piping
- Industry-specific functions for sheet metal processing suited for all machine technologies
- Unique optimization of material reduction
- Realistic and interactive machining simulation
- Control of optional machine equipment
- Customized post processors and workshop sheets
- Missler has more than 20 years industry experience

The Integrated CAD/CAM Solution

www.topsolid.com

 **Missler**
SOFTWARE

TopSolid'PunchCut

Punching and cutting, the perfect combination

TopSolid'PunchCut is an industry-specific solution for sheet metal processing featuring comprehensive integration of CAD/CAM and ERP (Entreprise Resource Planning). From design to manufacturing, this powerful, flexible and communicative software helps to dramatically increase productivity and to easily manage data within an enterprise.

Data retrieval

- Retrieval of DXF and DWG scales

Punching

- Automatic machining: recognition of specific tools, customized macros for manufacturing
- Automatic turret assembly and/or utilization of pre-defined turrets
- Slitting/common cuts, shearing
- Management of part removal and chippings: micro-attachments, hatches, unloaders
- Integration of optional equipment
- Calculation of repositioning, turning and punching operations with grippers in automatic mode
- Customizable post processors

Cutting

- Control of all types of cutting machines (laser cutting, flame cutting, plasma cutting, etc.)
- Control of the third axis (tube) for laser machines
- Common cut control
- Dynamic visualization of cutting heads during simulation

Automated manufacturing

- Optimum placement of sheet metal parts on rectangular or other pre-cut parts
- Management of part priorities taking into account manufacturing requirements
- Selection of the most adequate type of placement

Drawings and BOMs

- Associative with 3D models (TopSolid'Fold)
- Comprehensive viewing functions, especially for sheet metal processing
- BOMs, customizable title blocks

Integration with PPC

- TopSolid'PunchCut is completely integrated with the TopManufacturing solution for ERP.



Desk of a vibroscope, MG Cimadomo 38 Meylan.

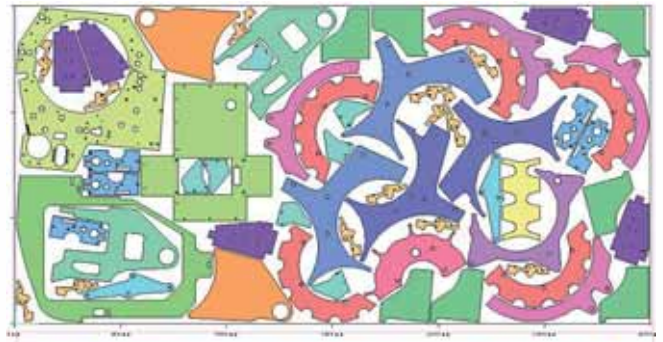

A complex nesting generated with TopSolid'Cut.



Tube machining with TopSolid'CutTube.

About Missler Software

Missler Software is the second largest French supplier of CAD, CAM, ERP and PDM solutions. The company's product lines include TopSolid, TopManufacturing and GOelan. Missler Software originated from the merger of Missler Informatique, TopCad, Catalpa and CN Industries. As a result, Missler's product portfolio includes comprehensive modern software solutions for the mechanical engineering industry (general mechanical design, special machinery, tooling, boilerwork, ...) and for sheet metal and wood industries. Companies around the world are using TopSolid solutions - the export share of this product line amounts to more than 60%.

Missler Software

7, rue du Bois Sauvage - 91055 Evry, France
Tel: +33 (0)1 60 87 20 20 - Fax: +33 (0)1 60 87 20 18
E-mail: international@topsolid.com